

WPE-I H 230

WPE-I 04 H 230 Premium
WPE-I 06 H 230 Premium
WPE-I 08 H 230 Premium
WPE-I 12 H 230 Premium
WPE-I 15 H 230 Premium

Product features

- › Geothermal heat pump for hot water and heating
- › Made in Germany
- › Year-round optimal operation and maximum efficiency thanks to inverter technology
- › High flow temperatures of up to 75 °C for energy-efficient heating and large amounts of mixed water
- › Future-proof and environmentally friendly refrigerant
- › Optional integration into the home network and control via smartphone



WPE-I H 230

Comfort moves into your home with the WPE-I H Premium inverter geothermal heat pumps. This device uses the heat from the ground for heating and hot water operation. The year-round constant heat output with high flow temperatures offers maximum living comfort regardless of the season.

Dimensions

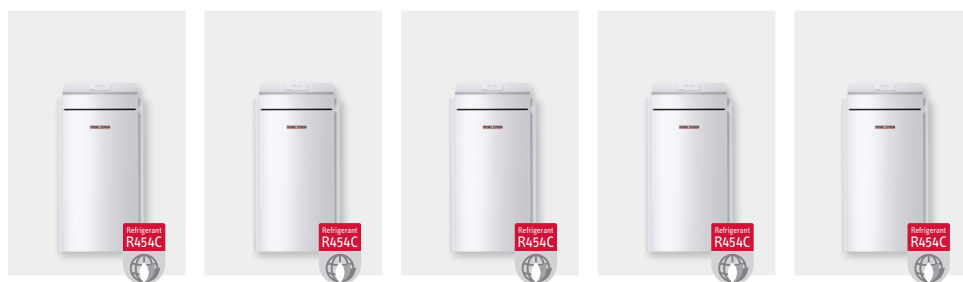
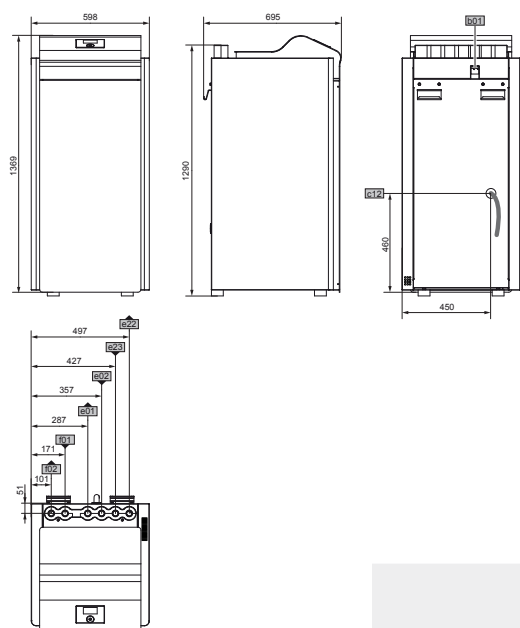

PREMIUM

Model	WPE-I 04 H 230	WPE-I 06 H 230	WPE-I 08 H 230	WPE-I 12 H 230	WPE-I 15 H 230
Phases Rated voltage	Single 230 V	Single 230 V	Single 230 V	Single 230 V	Single 230 V
Output at B0/W35 (EN 14511)	4.19 kW	6.57 kW	7.64 kW	12.66 kW	14.78 kW
Coefficient of performance at B0/W35 (EN 14511)	4.60	4.60	4.67	5.01	4.86
Sound power level (EN 12102)	38 - 40 dB(A)	38 - 43 dB(A)	39 - 45 dB(A)	39 - 46 dB(A)	39 - 47 dB(A)
Sound pressure level at 5 m distance in a free field	17 - 18 dB(A)	17 - 21 dB(A)	17 - 23 dB(A)	17 - 24 dB(A)	17 - 25 dB(A)
Max. flow temperature	75 °C	75 °C	75 °C	75 °C	75 °C
Domestic hot water *	■	■	■	■	■
Pool heating *	■	■	■	■	■
Inbuilt heat pump manager	■	■	■	■	■
Refrigerant	R454C	R454C	R454C	R454C	R454C
Height Width Depth	1369 598 658 mm	1369 598 658 mm	1369 598 658 mm	1369 598 658 mm	1369 598 658 mm
Weight	180 kg	180 kg	180 kg	190 kg	190 kg

STIEBEL ELTRON is committed to our policy of continual improvement, some features may have subsequently been changed or even removed. Our advisors will be happy to consult with you regarding the currently applicable equipment features. The images used in this data sheet are for reference only.